

35 Years of Airbrush Makeup Innovation

DINAIR®

AIRBRUSH SYSTEMS

JX2 Airbrush

“For the spray to be flawless, the nozzle tip must be perfectly clean”



The Secret of the Perfect Spray

The Perfect Dinair Makeup Spray is created when the nozzle tip is polished so clean that the air focused at the airbrush tip can sheet flawlessly along the surface of the nozzle and the needle tip.

Pulling the makeup lever back slightly, releases makeup from the nozzle tip directly into the center of the flawlessly formed air stream. When the makeup contacts the air stream, it is instantly lifted and pixelated into...

The Perfect Makeup Spray

Watch Our Training Videos
www.AirbrushHelp.com

Customer Service (800) 785-4770

JX2 Airbrush

Daily Care

Deep Clean Spray Tip with Brush

BRUSH & Polish Tip BEFORE USE

Completely remove dry makeup build-up from Needle & Nozzle Tip.

1. Twist off Air Cap to access Tip.
2. Use 2-3 drops of **Airbrush Cleaner**.
2. Brush Tip area vigorously to see polished silver color.
3. Wipe off Nozzle Tip area.
4. Put on Cap.

POLISHED Needle Tip

Nozzle Tip

Finger Nail Technique

Pinch off Makeup Build-up

PINCH & Scrape Tip

1. Use finger nail edges, not soft finger tips, to pinch and scrape off buildup until next full **Brush & Polish Cleaning**.
2. Put on Air Cap.

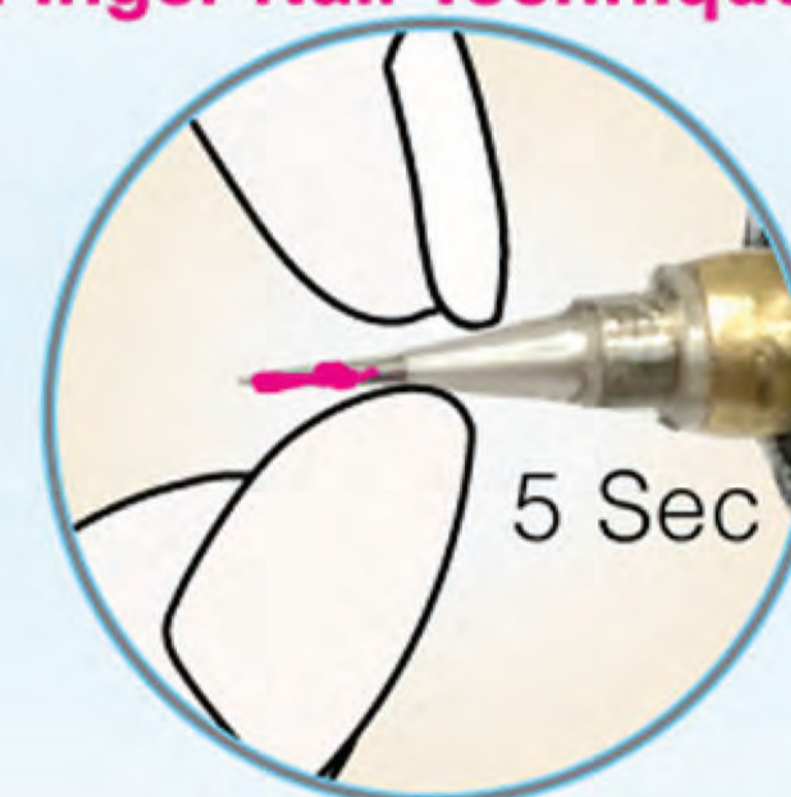

Deep Clean Inside Airbrush

Keep Cleaner in Cup Between Uses

Cap & Start
Deep Cleaning
in 20 Secs

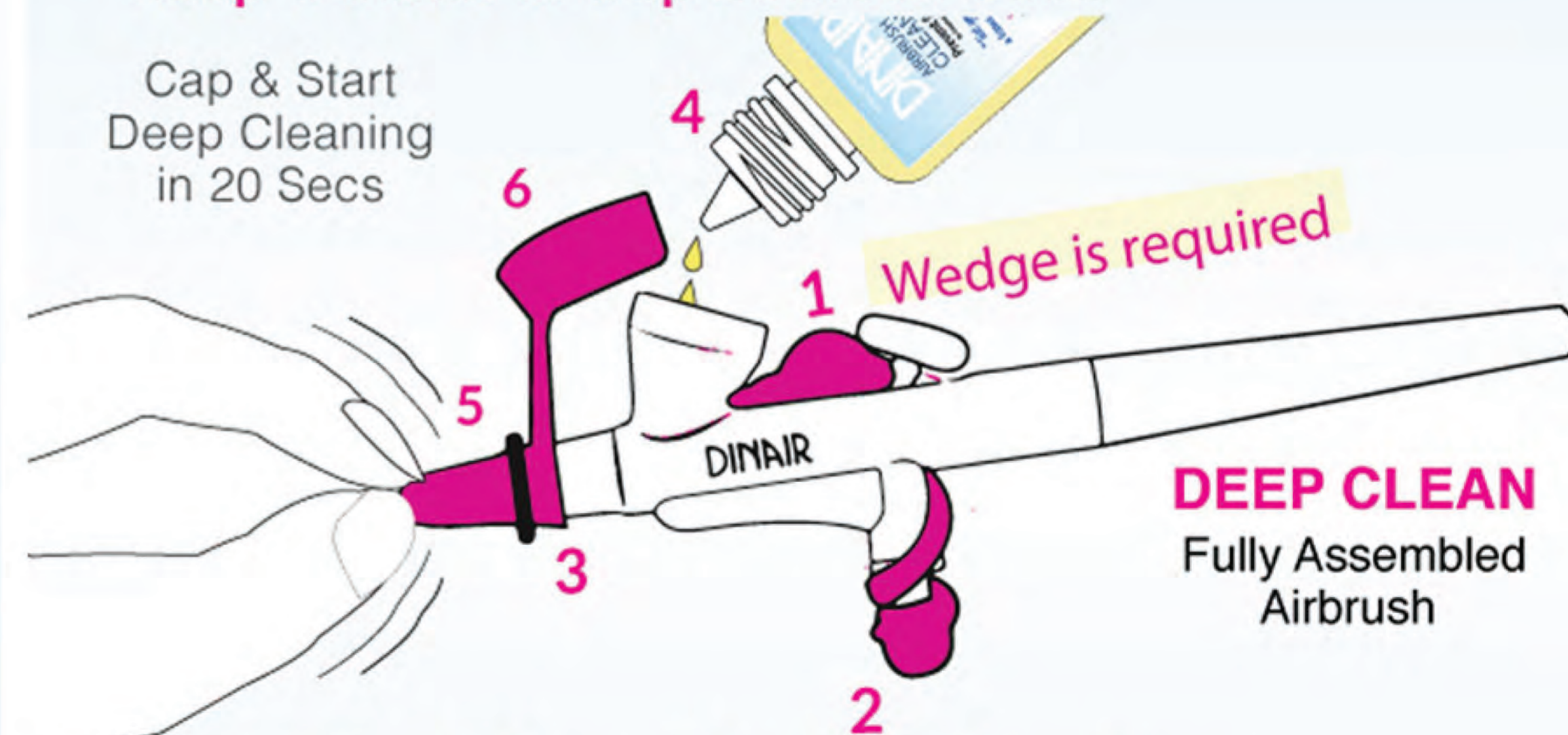

Dinair Travel & Cleaning Caps

1. **Wedge is required** for Cleaner to soak inside Nozzle and around airbrush needle.
2. Put Cap on Air Connect.
3. Nozzle Cap is pushed on, up to black line.
4. Add 5-10 drops of Dinair Airbrush Cleaner.
5. Pump Cap Tip "briefly" to circulate Cleaner.
6. Put on Makeup Cup Cap and store.

35 Years of Airbrush Makeup Innovation

DINAIR®

AIRBRUSH SYSTEMS

CX Airbrush

“For the spray to be flawless, the nozzle tip must be perfectly clean”

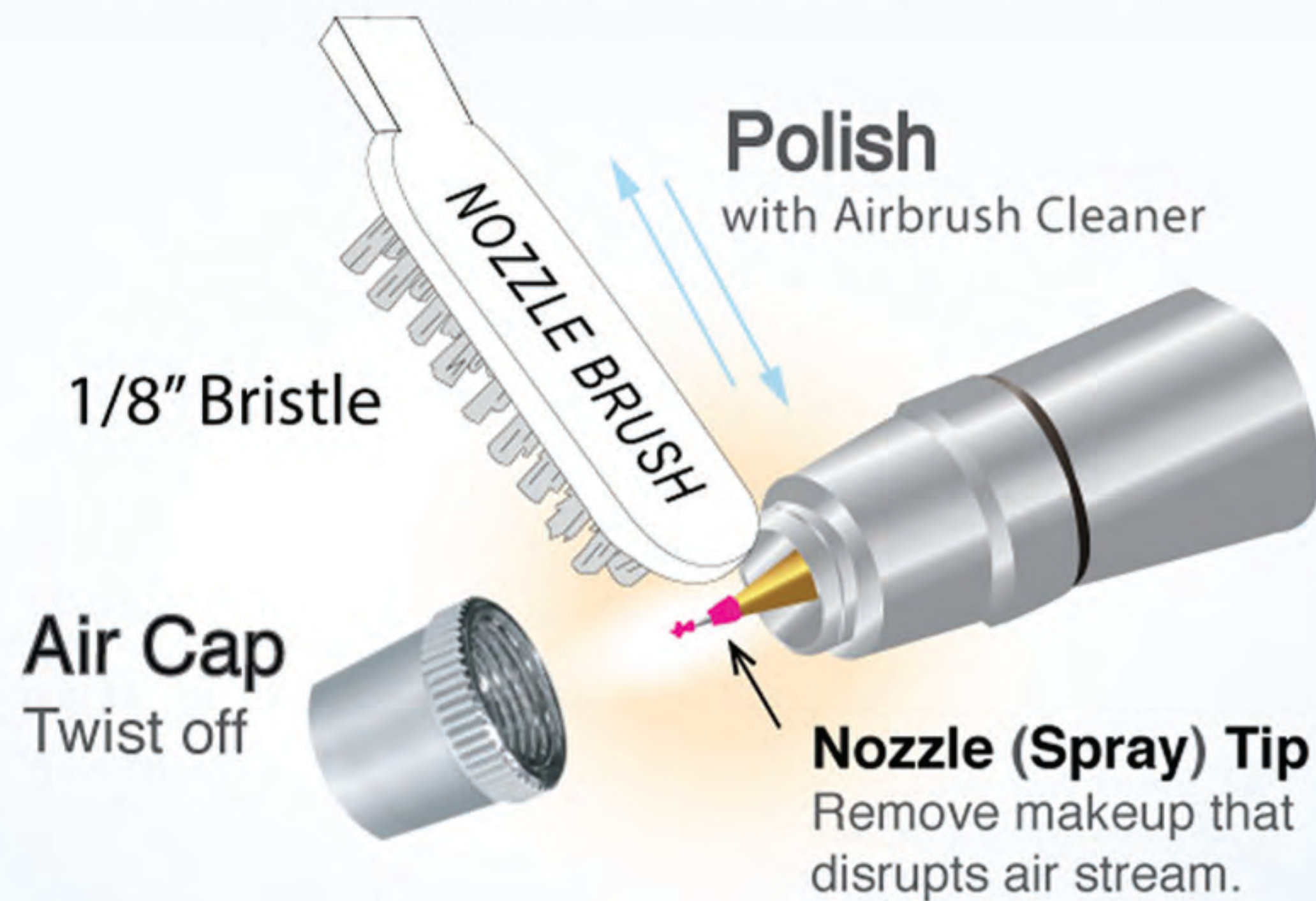

The Secret of the Perfect Spray

The Perfect Dinair Makeup Spray is created when the nozzle tip is polished so clean that the air focused at the airbrush tip can sheet flawlessly along the surface of the nozzle and the needle tip.

Pulling the makeup lever back slightly, releases makeup from the nozzle tip directly into the center of the flawlessly formed air stream. When the makeup contacts the air stream, it is instantly lifted and pixelated into...

The Perfect Makeup Spray

Watch Our Training Videos
www.AirbrushHelp.com

Customer Service (800) 785-4770

CX Airbrush Daily Care

Deep Clean Spray Tip with Brush

BRUSH & Polish

BEFORE USE

Remove dry makeup build-up from Needle & Nozzle Tip, before each use.

1. Twist off Air Cap to access Tip.
2. Use 2-3 drops of Airbrush Cleaner.
2. Brush Tip area vigorously to see polished silver and brass color.
3. Wipe off Nozzle Tip area.
4. Put on Cap.

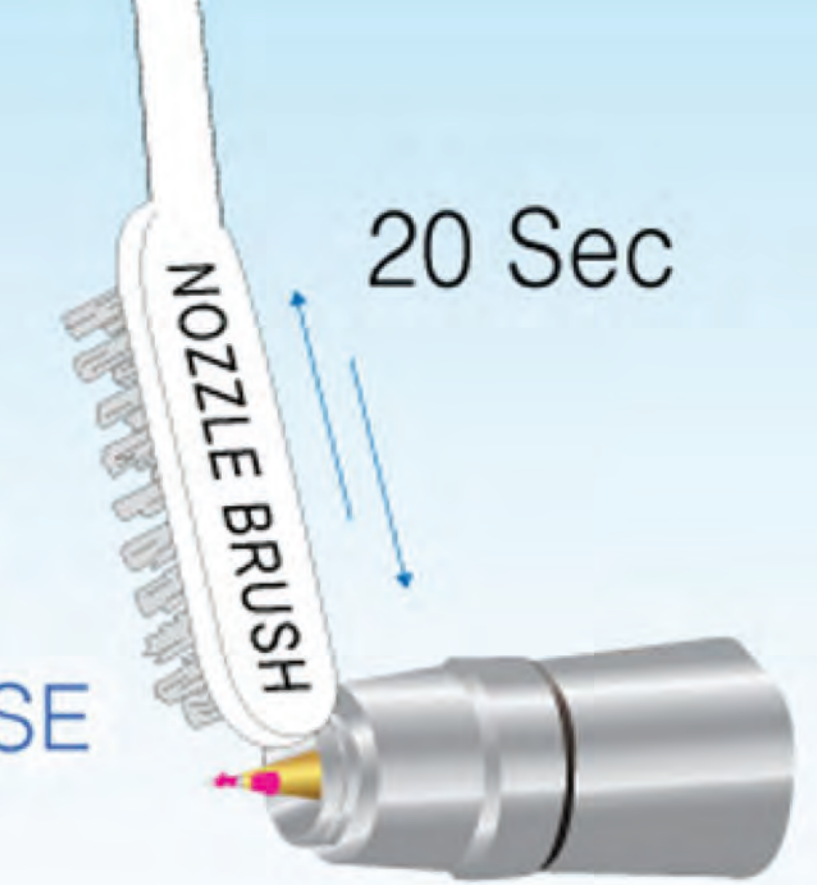

POLISHED

Needle Tip

Nozzle Tip

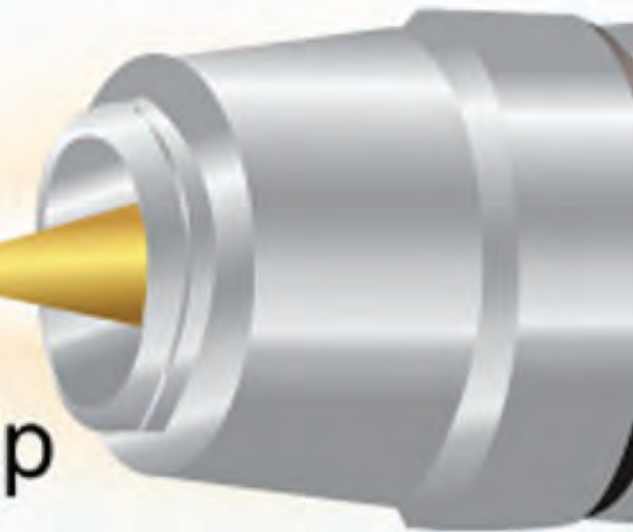

Partial Clean, Between Brushings

PINCH & Scrape

1. Use finger nail edges, not soft finger tips to pinch and scrape off buildup until next full Brush & Polish Cleaning.
2. Put on Air Cap.

MAKEUP BUILD-UP

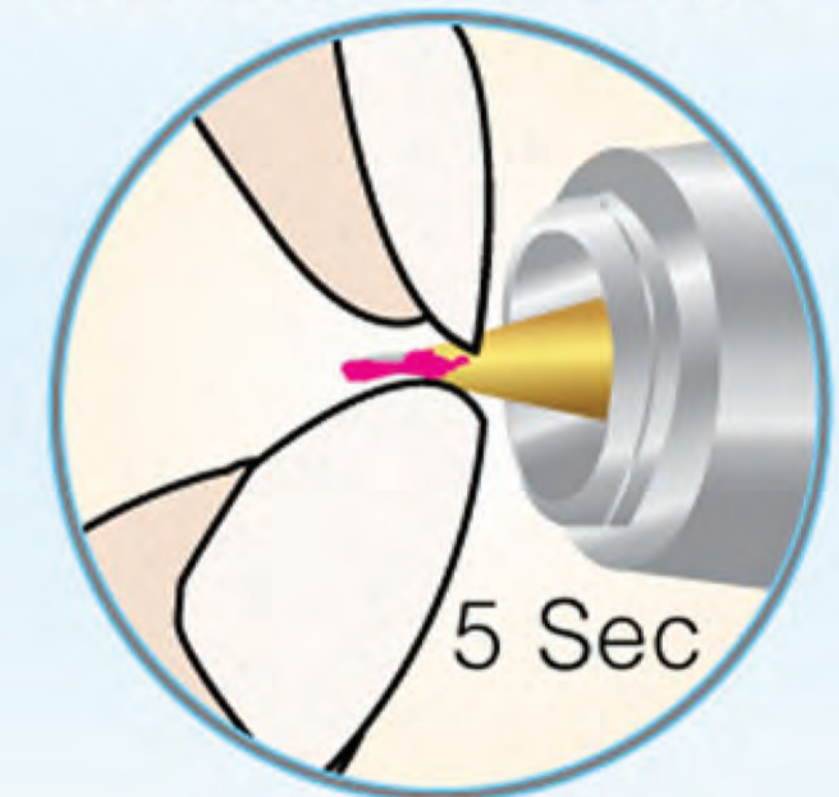

Deep Clean Inside Airbrush

Keep Cleaner in Cup Between Uses

20 Sec to Cap

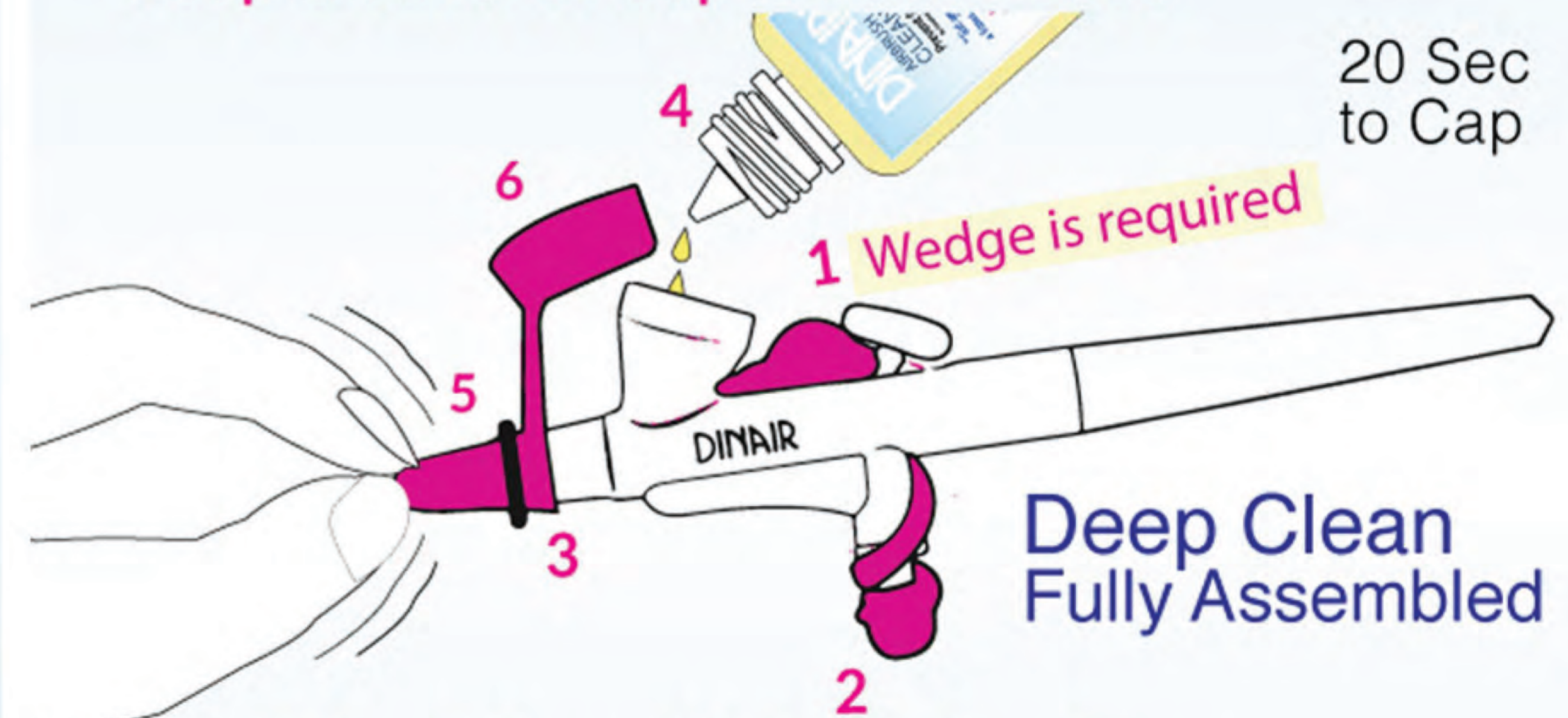

Dinair Travel & Cleaning Caps

1. **Wedge is required** for Cleaner to soak inside Nozzle and around airbrush needle.
2. Put Cap on Air Connect.
3. Nozzle Cap is pushed on, up to black line.
4. Add 5-10 drops of Dinair Airbrush Cleaner.
5. Pump Cap Tip "briefly" to circulate Cleaner.
6. Put on Makeup Cup Cap and store.